

Windows BYOD Device Enrollment Steps

We strongly recommend the enrolment process is completed by the student (with parent assistance if necessary) so that students are familiar with this process.

1. If your BYOD device is brand new, complete your initial device setup and login with the account you (the student) will be using.
2. Open the Microsoft Store and Search for “Company Portal”, [or click this link to take you straight there.](#)

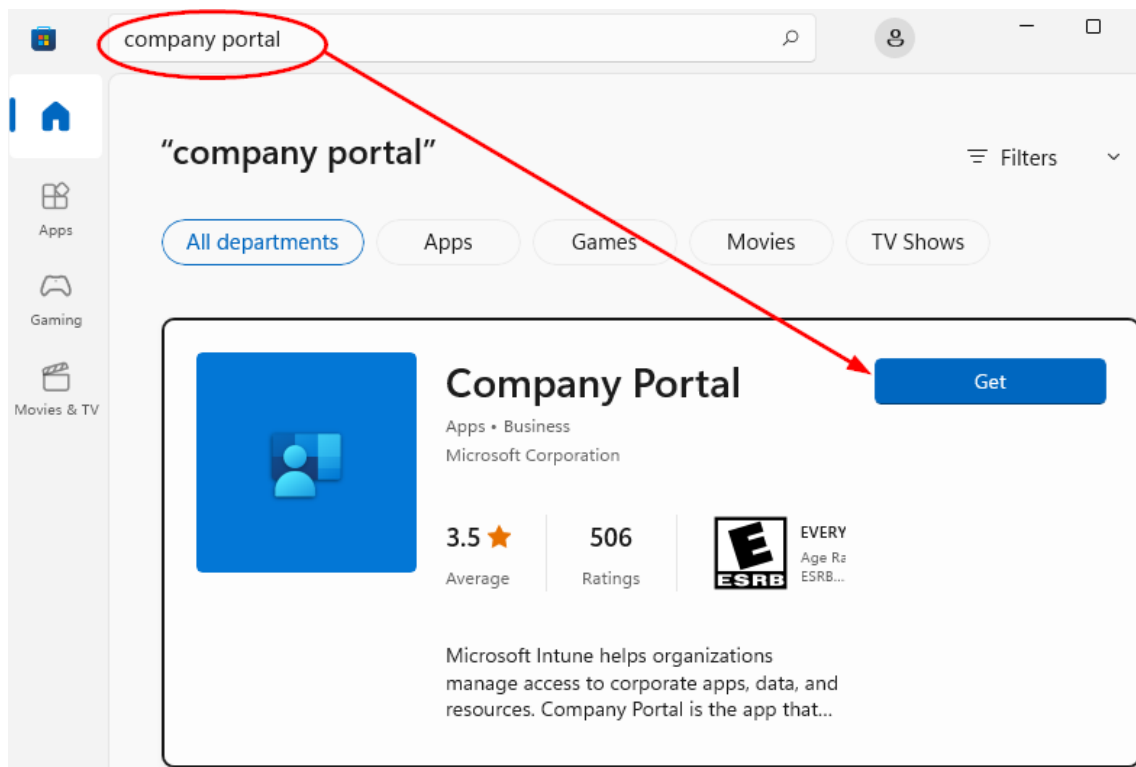

3. Click the **Get** button to install the application. You may be prompted to sign in with a Microsoft account, but this can be closed/skipped and the app will still download and install.
4. Once the download has completed, launch the Company Portal application from the Start Menu.
5. You will be prompted to sign-in with a Microsoft account. Your **Oakhill College student account** must be used here to sign in.

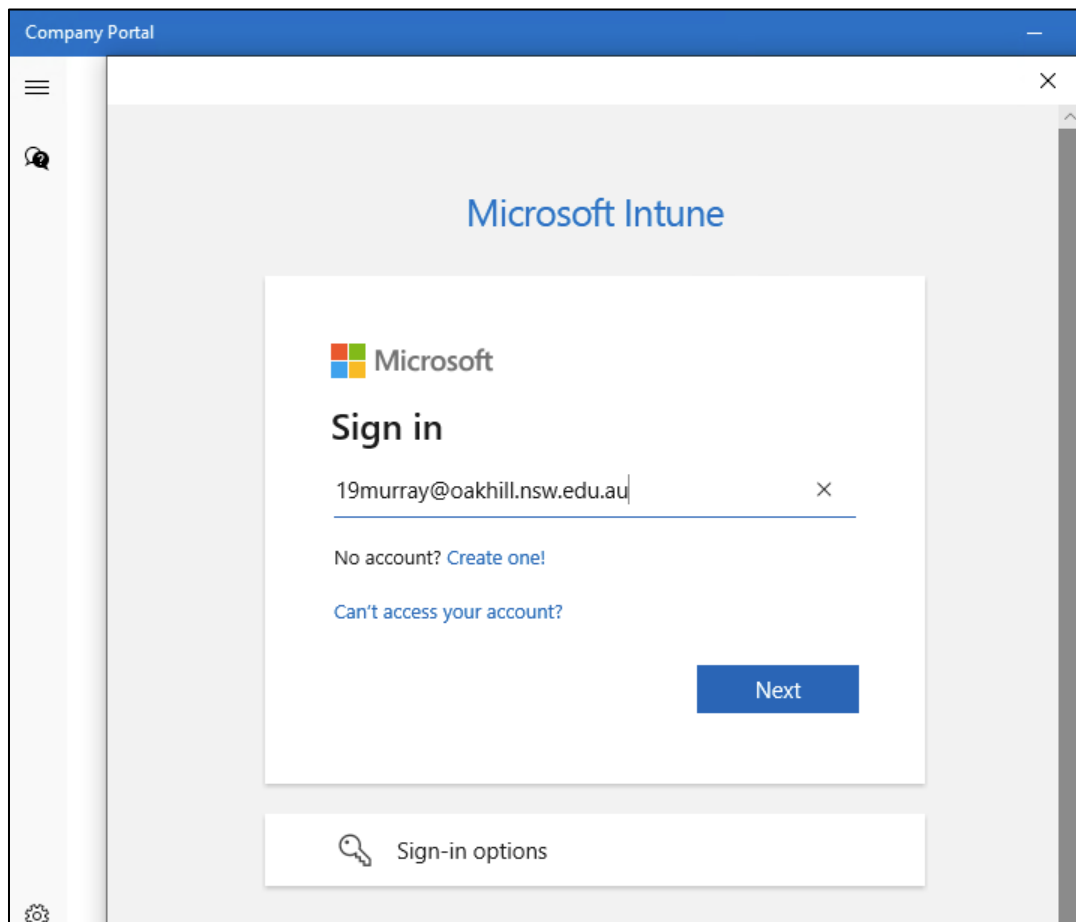

6. Ensure the option to Allow my organisation to manage my device is ticked then click OK. This option is required to allow the installation of software applications provided by Oakhill College, such as Microsoft Office and Adobe Creative Cloud.

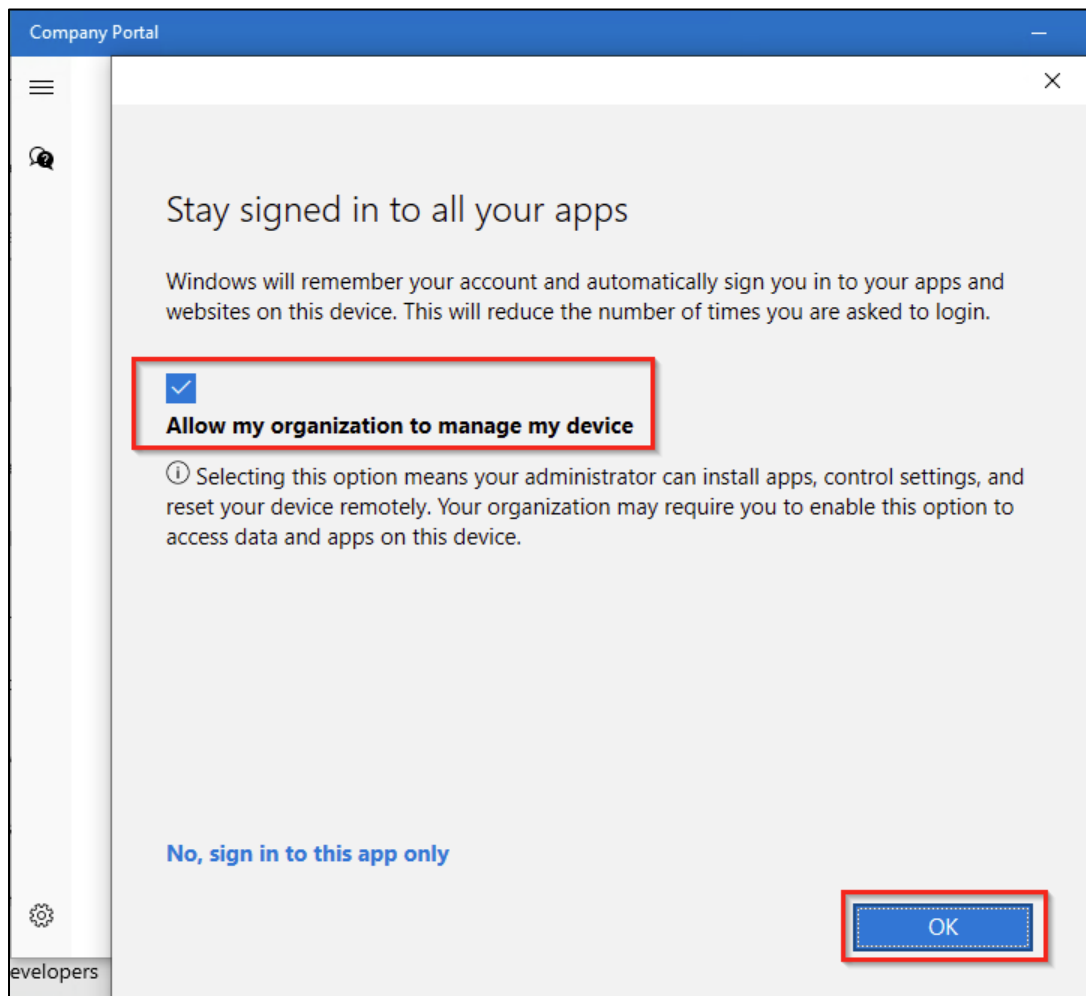

7. The device will now be registered into Intune and appropriate College network settings are applied.

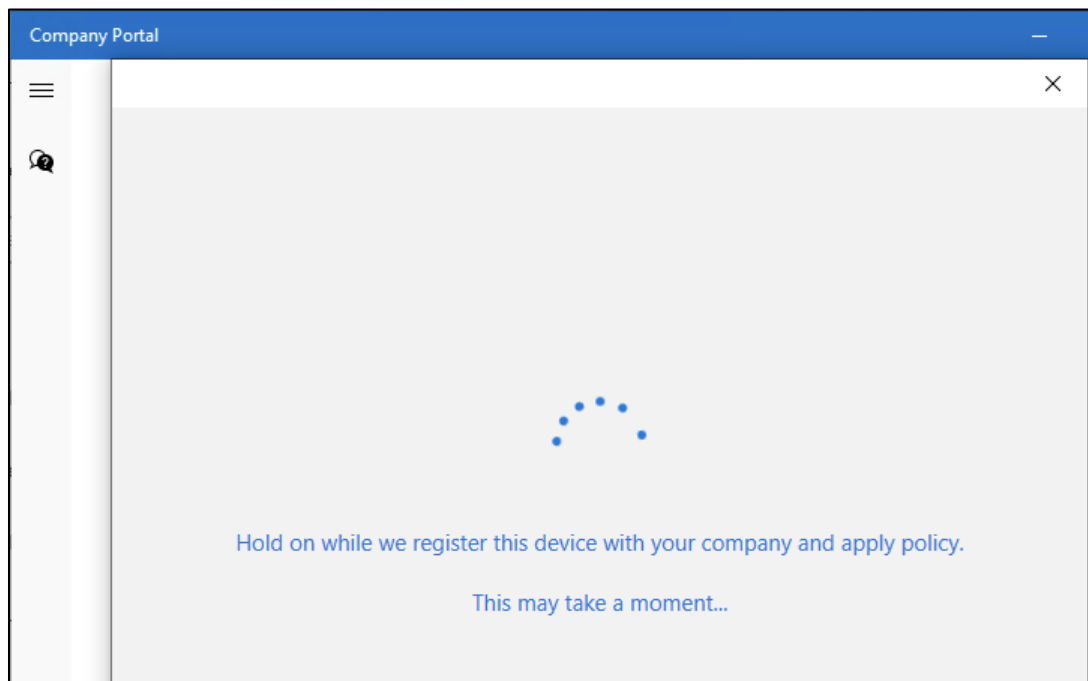

8. Once completed, you'll be taken to the Company Policy app which should look similar to this:

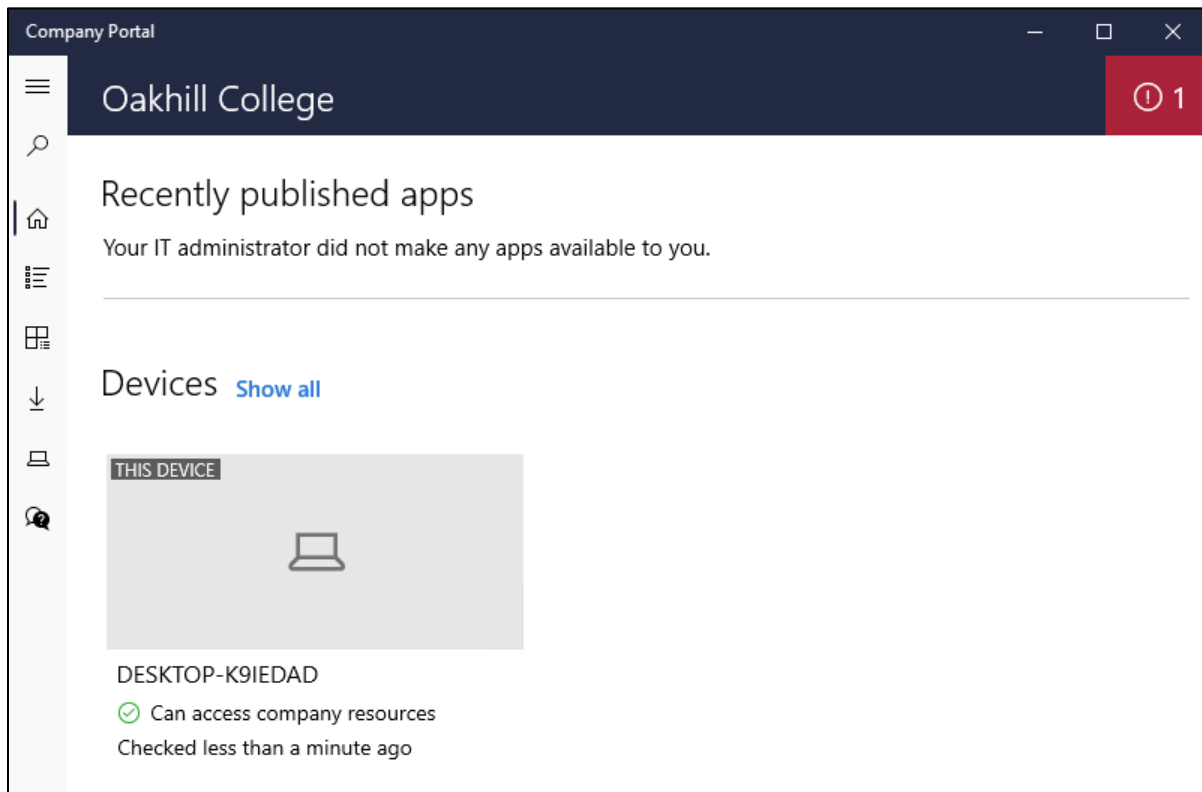

NB: If your screen says "This device hasn't been set up for corporate use yet. Select this message to begin setup" then click on the message and add the following for **MDM server**:
<https://EnterpriseEnrollment-s.manage.microsoft.com>



-
9. Nothing further is required after this point, but there are subsequent processes that are automatically triggered after initial enrollment is completed.
 10. Note: if your device is running a “Home” version of Windows, it will be automatically updated to the “Education” version shortly after enrolling the device in Intune. This upgrade is free and is included as part of Oakhill College’s Microsoft Licensing agreement for students, and enables all the required features of Intune that aren’t available for devices running Windows Home versions.
 11. You may be prompted to sign out/restart your computer once the update to Windows Education has completed.

We recommend leaving your laptop switched on, connected to its charger and Wi-Fi for 24 hours, to allow the enrollment processes to be completed. During this time, you can continue to use your laptop as you wish.

Microsoft Intune FAQ

What Intune does:

Microsoft Intune allows Windows and Mac BYOD devices to be automatically configured for use at Oakhill College. This includes:

- Enable Wi-Fi Connectivity to the College network.
- Enable automatic setup of the device’s default email application (eg: Microsoft Outlook) to add the student’s Oakhill email account.
- Enable access to a selected list of BYOD applications.
- Automatically distribute and install essential Oakhill BYOD software.
- Allows students the ability to remove the device from Intune.
- Allows students the ability to ‘factory reset’ a lost or stolen device.
- Provide confirmation of applications installed through Intune.
- Provide limited information to Oakhill ICT Services, such as device name, device serial number, model, manufacturer, operating system name and version.

What Intune does not do:

- Does not monitor student use of the BYOD device.
- Does not track a student’s location.
- Does not collect information on personal software applications.
- Does not remove personal software applications.